



Quick Reference Guide

Manufactured for:
TRIVIDIA HEALTH
FORT LAUDERDALE, FL 33309 U.S.A.

Customer Consultation
English or Spanish, Monday - Friday,
8AM-8PM EST, 1-800-803-6025
www.trividiahealth.com

1. FDA Public Health Notification: Use of Fingerstick Devices on More than One Person Poses Risk for Transmitting Bloodborne Pathogens: Initial Communication. Available at <https://wayback.archive-it.org/7993/20170111013014/http://www.fda.gov/MedicalDevices/SafetyAlertsandNotices/ucm224025.htm>.
2. Glucose Monitoring and Insulin Administration Available at <https://www.cdc.gov/injectionsafety/blood-glucose-monitoring.html>.

© 2024 Trividia Health, Inc. TRUENESS and Trividia Health logo are trademarks of Trividia Health, Inc. Made in China.



Caution: Before testing, please read the Owner's Booklet and this Quick Reference Guide carefully.

Blood Glucose Meter



Lancing Device and Lancet

Images are for illustration purposes only. Your lancing device/lancet may look different. Refer to your lancing device/lancet instructions for use for detailed information.

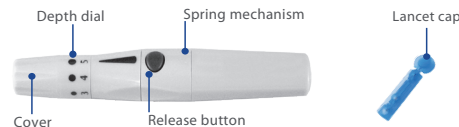

Test Strip

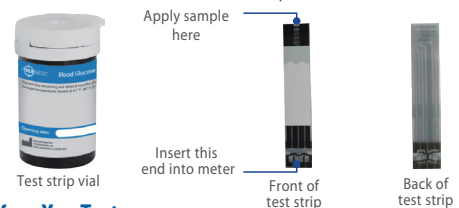

Before You Test

- ✓ Contact your Doctor or Healthcare Professional to determine how often you should test and what your target ranges are for blood glucose results.
- ✓ ALWAYS read the Owner's Booklet before testing for the first time and before using this Quick Reference Guide.

1

Let's start the blood glucose test now



Wash hands. Rinse well. Dry thoroughly. Refer to lancing device Instructions for Use for detailed instructions on cleaning and disinfecting the fingertip.

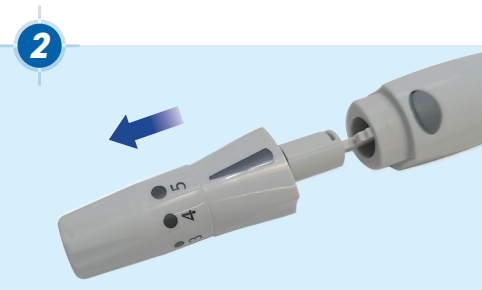

Pull to remove the lancing device cover.

2



Insert a lancet into the lancing device until it comes to a full stop. Remove the lancet cap.



Push the lancing device cover back on.

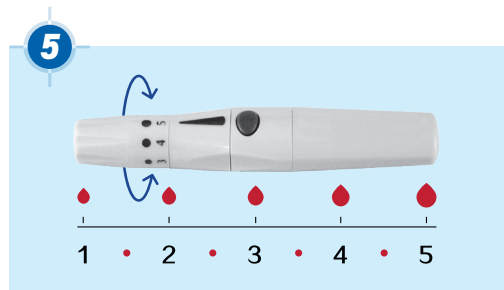

Twist the depth dial to adjust the puncture depth. Choose a higher number for deeper puncture depth.

3

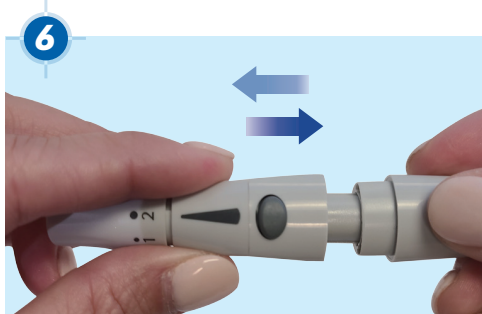

Pull the spring mechanism back to arm the lancing device.



Remove one test strip from vial. Close vial immediately. Use test strip quickly after removal from vial.

4



With meter off, insert test strip contact end (blocks facing up) into Test Port. Meter turns on. Keep test strip in meter until testing is finished.



Make sure the lancing device is pressed firmly to your finger. Press the release button to lance. Attention: If you did not produce a large enough blood sample, gently massage your finger. DO NOT SQUEEZE YOUR FINGER. Adjust the puncture depth and lance again.

5



With test strip still in meter, the meter screen displays the flashing blood symbol, apply the blood sample to the **tip** of the Test Strip. **Hold the tip of the test strip to the blood drop until the meter beeps.**



After a 5-second count down, meter displays the test result.

6



Hold meter with test strip pointing down. Press test strip release button to discard test strip according to your healthcare professional's instructions or dispose them in an appropriate trash container. Meter turns off.



Remove the lancing device cover. With the lancet cap on the table, stick the needle of the lancet into the lancet cap and remove lancet from lancing device. Please discard them carefully according to your healthcare professional's instructions or dispose them in an appropriate trash container. Replace the lancing device cover.

7